

## PROJECT

### THE VICTORIAN BARN, WEST SUSSEX

## LOCATION

VICTORIAN BUSINESS CENTRE, FORD LANE, FORD BN18 0EF

## SUMMARY

- A fabulous converted Victorian Barn with beautiful surroundings
- Plenty of Parking
- Multiple uses Offices, Workspace, Health and Beauty, IT, R&D, STP
- Circa 3,900ft<sup>2</sup> – see floor plan on next page
- Easy access and good road visibility in Littlehampton Bognor conurbation
- Short distance from Ford Railway Station

## PARKING

Plenty of free parking for staff customers and deliveries

## SERVICES

- Electricity
- Water

## RATEABLE VALUE

Rates payable 21750 x 0.499 is 10,853 per annum

## TERMS & TENURE

Flexible terms to be agreed for the right Occupier

IMPORTANT NOTES. PLEASE READ CAREFULLY: This business and or property are offered subject to contract, availability and confirmation of the details. These particulars do not form part of any contract and, while believed to be correct, parties are recommended to satisfy their accuracy. The vendors, lessors or Commercial Property Associates or any person in their employ, cannot give or make any representations whatsoever in relation to this business or property. Appliances or services have not been checked or tested.

## CONFIDENTIAL PRELIMINARY DETAILS

Arrangement with this office only,  
at any reasonable time.



**CONTACT:**  
CPA property Chartered Surveyors

01798 831250

nicola@cpaproperty.co.uk

www.cpaproperty.co.uk

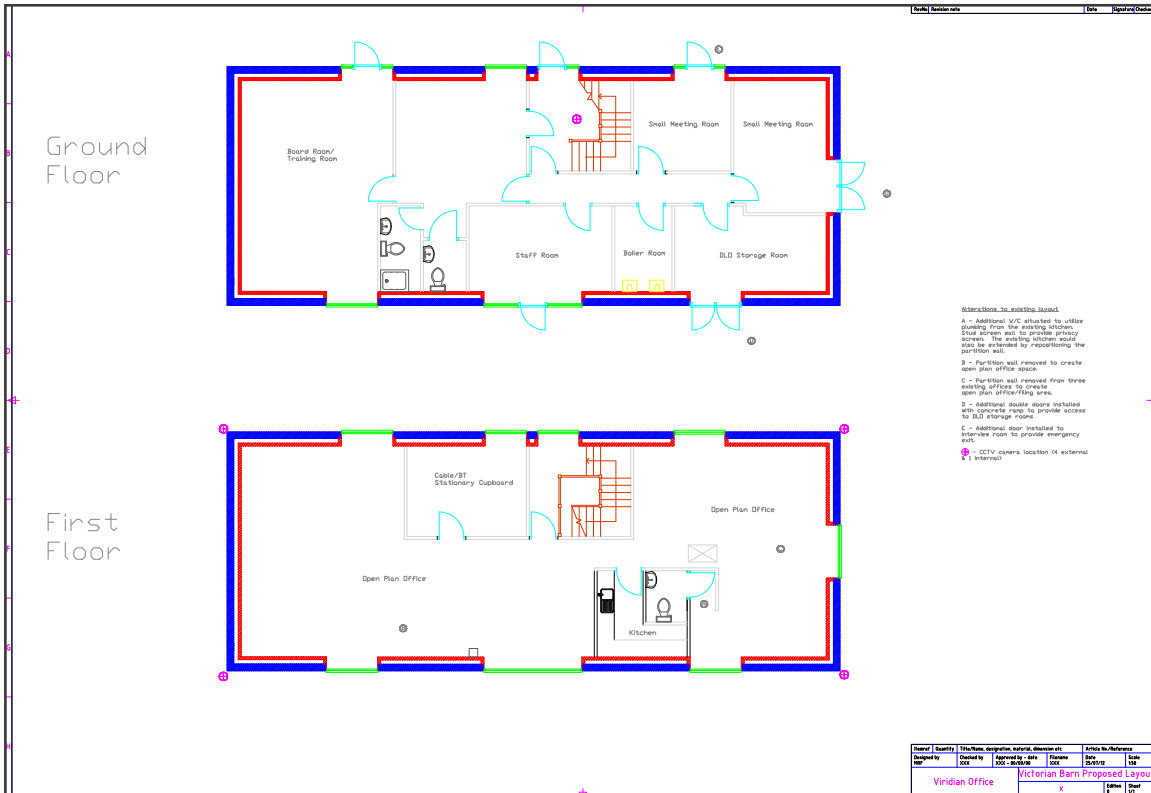

**IMPORTANT NOTES. PLEASE READ CAREFULLY:** This business and or property are offered subject to contract, availability and confirmation of the details. These particulars do not form part of any contract and, while believed to be correct, parties are recommended to satisfy their accuracy. The vendors, lessors or Commercial Property Associates or any person in their employ, cannot give or make any representations whatsoever in relation to this business or property. Appliances or services have not been checked or tested.



**CONTACT:**  
**CPA property Chartered Surveyors**  
**01798 831250**  
**nicola@cpaproperty.co.uk**  
**www.cpaproperty.co.uk**